

WHS55

Cable System



50P / 68P / 100P



100P-50Px2

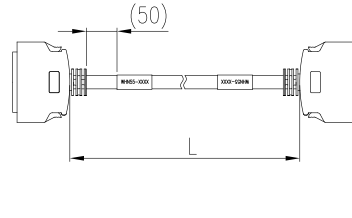

50P / 68P / 100P

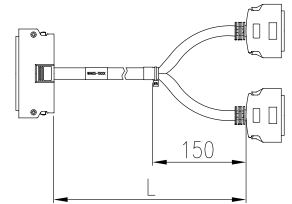

100P-50Px2

The web catalog is for reference only. Dinkle remains the right of product modification and engineering change of the design.
The final product is made according to engineering drawing.

Specification

| Connecting poles | Length | | | | | |
|------------------|-------------|-------------|-------------|-------------|-------------|-------------|
| | 0.5 m | 1 m | 2 m | 3 m | 4 m | 5 m |
| 50P | WHS55-5005 | WHS55-5010 | WHS55-5020 | WHS55-5030 | WHS55-5040 | WHS55-5050 |
| 68P | WHS55-6805 | WHS55-6810 | WHS55-6820 | WHS55-6830 | WHS55-6840 | WHS55-6850 |
| 100P | WHS55-0005 | WHS55-0010 | WHS55-0020 | WHS55-0030 | WHS55-0040 | WHS55-0050 |
| 100P-50Px2 | WHS55-T0005 | WHS55-T0010 | WHS55-T0020 | WHS55-T0030 | WHS55-T0040 | WHS55-T0050 |

*Shielded