

RES2-80-1PN1

RES2- Series AC power SPD

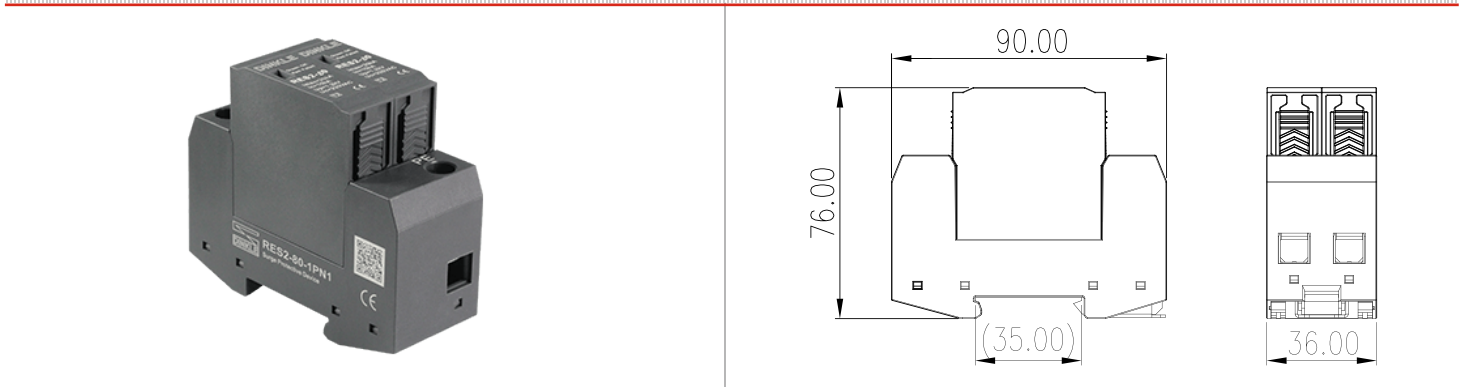



Specification

SPD according to IEC 61643-11	II
Parameter	Single phase TT
Max, operating voltage Uc	255VAC
Nominal discharge cur. In(8/20μs)	40kA
Max. discharge cur. In(8/20μs)	80kA
Protection level Up	1.2kV
Max. backup fuse	125A gG
Short-circuit current rating I _{SCCR} (without backup fuse)	1000A
Connection wire section area L/N	4~35mm²
Connection wire section area PE	6~35mm²
Stripping length	12~14mm
Tightening Torque	2.0~3.0Nm
Response time	<25 ns
Operating temperature range	-40 °C ~ +70 °C
Leakage current	< 20μA
Remote Signal(With F series)	-
Remote Signal Conductor cross section - Solid / Stranded	-
Remote Signal-Stripping length	-
Remote Signal-Maximum Tightening Torque	-
Housing protection level (IEC60529)	IP 20
Housing Material/flame-retarded level (UL94)	PA66 / V0
Test Standards	GB/T 18802.1 / IEC 61643-11
Package	10pcs
Dimensions mm(TxHxW)	36.0×76.0x90.0

Product certification

Lightning Performance Test	Shanghai lightning protection center
----------------------------	--------------------------------------

Approvals

