

# KMRF-XXXX

PCB Carrier

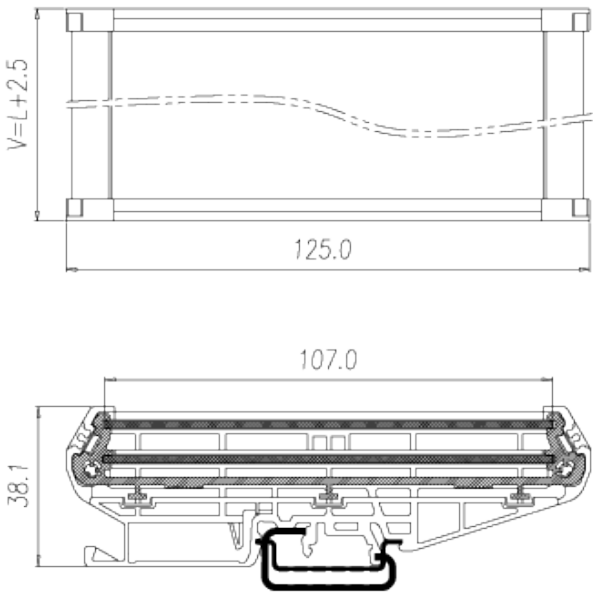

## Specification

|  |                   |
|--|-------------------|
| PCB width  | 107mm double deck |
| Panel mounting base – 1000mm                             | KMRFC-1000        |
| Panel mounting base – 2000mm                             | KMRFC-2000        |
| Right end cover  | KMRFMR            |
| Left end cover   | KMRFML            |
| Mounting foot (As the length of the mid-plate increases) | KMRF-PP           |
| Length(mm)   |                   |
| 60   | KMRF-0060         |
| :  | :                 |
| :  | :                 |
| 2000   | KMRF-2000         |