

DKM120

DIN Rail Terminal Blocks > Stud Connection

Date:2024-05-20

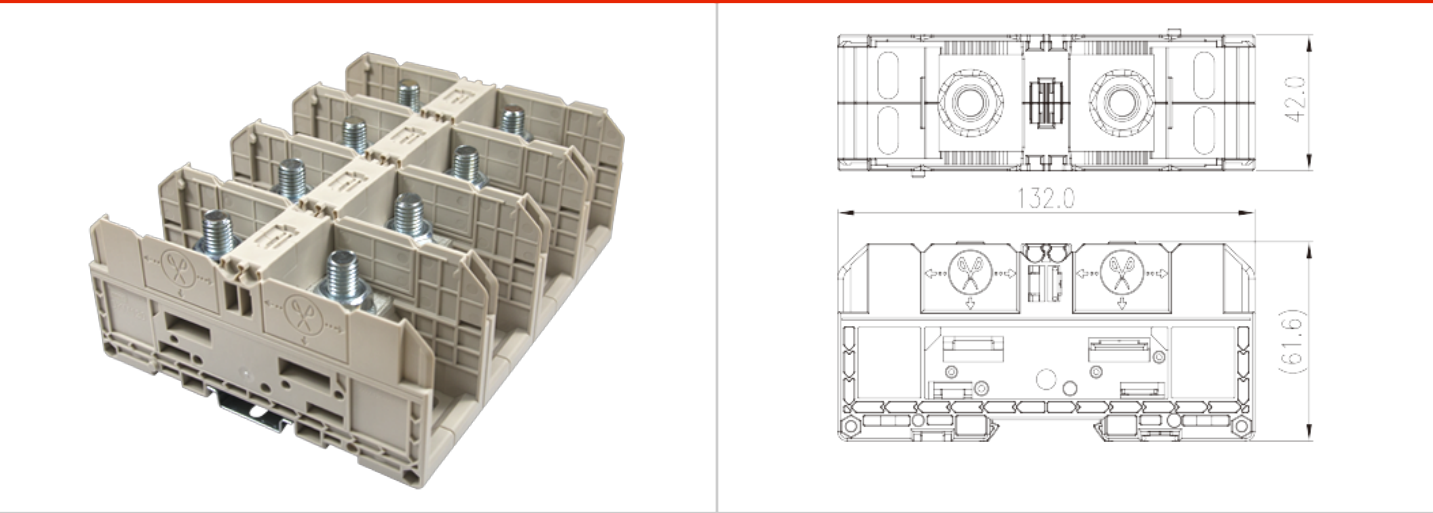

The web catalog is for reference only. Dinkle remains the right of product modification and engineering change of the design.
The final product is made according to engineering drawing.

Product Description

M10, 1500V, 300A, Beige (default)

General information

| | |
|-------------------|--|
| Short description | Panel Mounting DIN Rail terminal blocks, Stud Connection |
| Category | Feed-through Single Level |
| Pitch (mm) | 42 |
| Color | Refer to drawing |
| Connection method | Stud Connection |
| Type of locking | Panel Mounting/Rail Mounting |
| Length (mm) | 132 |
| Width (mm) | 42 |
| Height (mm) | 61.6 |
| Level | Single level |
| Connection points | 2 |

Material information

| | |
|---------------------------|----|
| Insulation material | PA |
| Insulation material group | I |

| | |
|--|-------------------|
| Flame retardant rating , compliant with UL94 | V0 |
| Insulation resistance | □500MΩ at DC 500V |

Connection data-IEC

| | |
|--|---|
| Rated voltage (V) | 1500 |
| Rated current (A) | 269 |
| Rated voltage (III/3)(V) | 1500 |
| Rated impulse voltage (III/3)(KV) | 8 |
| Conductor cross section solid. min (mm ²) | 6 |
| Conductor cross section solid.max (mm ²) | 120 |
| Conductor cross section stranded. min (mm ²) | 6 |
| Conductor cross section stranded. max (mm ²) | 120 |
| Screw thread | M10 |
| Rated torque (N.m) | 10~20 |
| Recommend tightening torque. min (N.m) | 10 |
| Recommend tightening torque. max (N.m) | 20 |
| Stripping Length (mm) | The stripping length depends on the specification provided by the cablelug manufacturer |
| Mounting rail | TS-35 |
| End cover plate required | NO |
| Grounding connections | NO |

Connection data-UL

| | |
|--|--|
| Rated voltage (UL/CUL Group E)(V) | 1500 |
| Rated current (UL/CUL Group E)(A) | *Single Cable 255A / Double Cable 300A |
| Min. solid wire connection (AWG) acc. to UL/CUL | 10 |
| Max. solid wire connection AWG acc. to UL/CUL | 250(kcmil) |
| Min. stranded wire connection AWG acc. to UL/CUL | 10 |
| Max. stranded wire connection AWG acc. to UL/CUL | 250(kcmil) |

Environment & Safety

| | |
|---|-----|
| Back of the hand protection (YES or NO) | NO |
| Finger protection (YES or NO) | NO |
| Operating temperature. max (°C) | 120 |
| Operating temperature. min (°C) | -40 |



UL Recognized

| | |
|----------------------------|--|
| Wire Range (Group E)(AWG) | 10~250(kcmil) |
| Rated voltage (Group E)(V) | 1500 |
| Rated current (Group E)(A) | *Single Cable 255A / Double Cable 300A |

CUL Recognized

| | |
|----------------------------|--|
| Wire Range (Group E)(AWG) | 10~250(kcmil) |
| Rated voltage (Group E)(V) | 1500 |
| Rated current (Group E)(A) | *Single Cable 255A / Double Cable 300A |

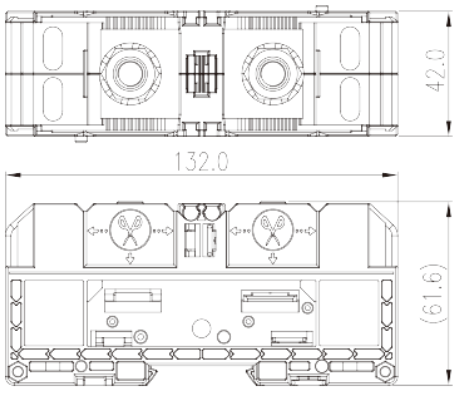
Drawings

| | |
|--|--|
|  |  |
|--|--|

Approvals

