

# DKB300-XXPCK

NEMA Terminal Blocks &gt; Panel Mounting

Date:2025-06-13

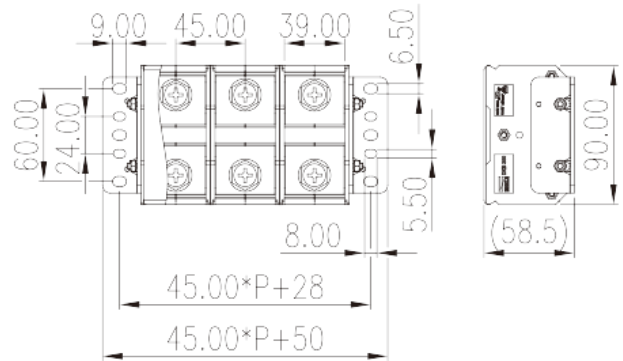

The web catalog is for reference only. Dinkle remains the right of product modification and engineering change of the design.  
The final product is made according to engineering drawing.

## Product Description

Pitch : 45.00mm, M10, 600V, 380A

## General information

Short description	Panel Mounting, Screw Connection
Category	Panel Mounting
Pitch (mm)	45.00
Color	Refer to drawing
Connection method	Screw connection
Type of locking	Panel Mounting
Length (mm)	45*P+50
Width (mm)	90
Height (mm)	Refer to drawing
Number of positions	01P~12P
Level	Single level
Connection points	2~24

## Material information

Insulation material	PC
Insulation material group	IIIa

Flame retardant rating , compliant with UL94	V2
Insulation resistance	□1000MΩ at DC 500V
Conductor material	COPPER ALLOY
Plating of conductor surface	Ni PLATED

## Connection data-IEC

Rated voltage (V)	1000
Rated current (A)	415
Rated voltage (III/3)(V)	800
Rated impulse voltage (III/3)(KV)	8
Screw thread	M10
Philips screwdriver size	PH4
Rated torque (N.m)	10
Stripping Length (mm)	The stripping length depends on the specification provided by the cable lug manufacturer
Grounding connections	NO

## Connection data-UL

Rated voltage (UL/CUL Group B)(V)	600
Rated current (UL/CUL Group B)(A)	380
Rated voltage (UL/CUL Group C)(V)	600
Rated current (UL/CUL Group C)(A)	380
Min. solid wire connection (AWG) acc. to UL/CUL	3/0
Max. solid wire connection AWG acc. to UL/CUL	500Kcmil
Min. stranded wire connection AWG acc. to UL/CUL	3/0
Max. stranded wire connection AWG acc. to UL/CUL	500Kcmil

## Environment & Safety

Back of the hand protection (YES or NO)	YES
Finger protection (YES or NO)	NO
Operating temperature. max (°C)	125
Operating temperature. min (°C)	-40

## UL Recognized

Wire Range (Group B)(AWG)	3/0~500kcmil 2x(6~3/0)
---------------------------	------------------------

Rated voltage (Group B)(V)	600
Rated current (Group B)(A)	380
Wire Range (Group C)(AWG)	3/0~500kcmil 2x(6~3/0)
Rated voltage (Group C)(V)	600
Rated current (Group C)(A)	380

## CUL Recognized

Wire Range (Group B)(AWG)	3/0~500kcmil 2x(6~3/0)
Rated voltage (Group B)(V)	600
Rated current (Group B)(A)	380
Wire Range (Group C)(AWG)	3/0~500kcmil 2x(6~3/0)
Rated voltage (Group C)(V)	600
Rated current (Group C)(A)	380

## VDE Approval

Wire Range (mm <sup>2</sup> )	70~240
Rated voltage (V)	1000
Rated current (A)	415

## Drawings

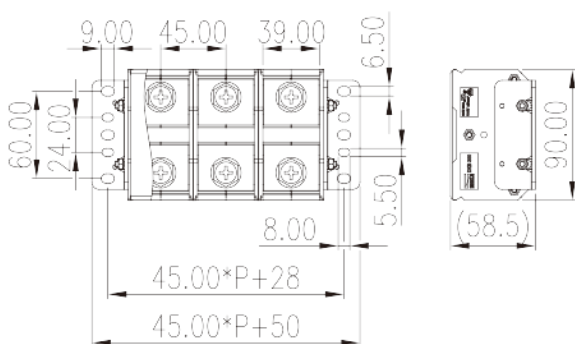

## Approvals



