

RES2-40-1500

RES2- Series DC power SPD

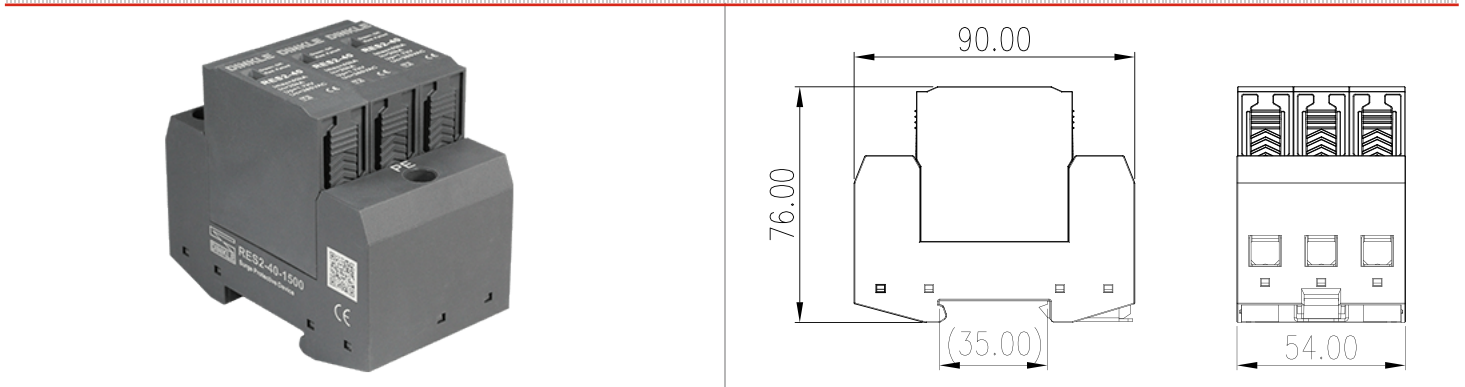



Specification

SPD according to IEC 61643-11	II
Max, operating voltage Uc	1500VDC
Short-circuit current rating Is	1000A
Nominal discharge cur. In(8/20μs)	20kA
Max. discharge cur. In(8/20μs)	40kA
Protection level Up	6kV
Max. backup fuse	80A gG
Short-circuit current rating I _{SCCR} (without backup fuse)	1000A
Connection wire section area L/N	4~35mm²
Connection wire section area PE	6~35mm²
Stripping length	12~14mm
Tightening Torque	2.0~3.0Nm
Response time	<25 ns
Operating temperature range	-40 °C ~ +70 °C
Leakage current	< 10μA
Remote Signal(With F series)	-
Remote Signal Conductor cross section - Solid / Stranded	-
Remote Signal-Stripping length	-
Remote Signal-Maximum Tightening Torque	-
Housing protection level (IEC60529)	IP 20
Housing Material/flame-retarded level (UL94)	PA66 / V0
Test Standards	GB/T 18802.31 / IEC 61643-31
Package	10pcs
Dimensions mm(TxHxW)	54.0×76.0x90.0

Product certification

Lightning Performance Test	Shanghai lightning protection center
----------------------------	--------------------------------------

Approvals

