

DPD10-P001

DIN Rail Terminal Blocks > Push-in Design

Date:2026-06-14

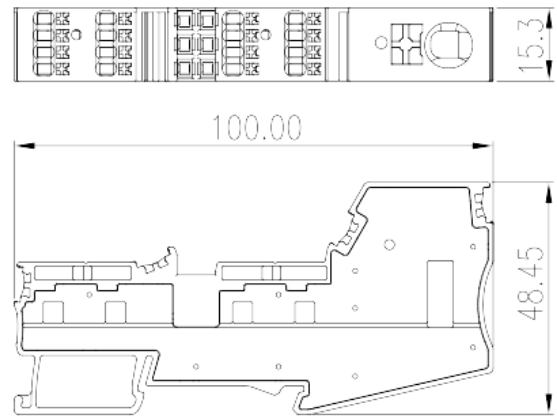
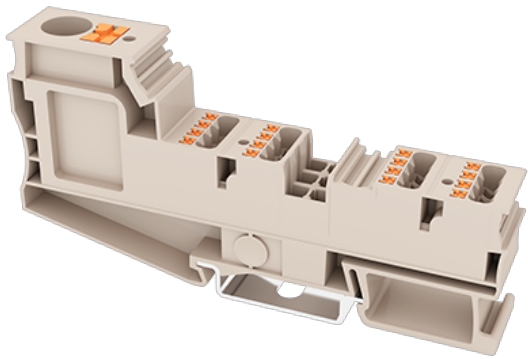

The web catalog is for reference only. Dinkle remains the right of product modification and engineering change of the design. The final product is made according to engineering drawing.

Product Description

600V, 50A, Beige (default)

General information

| | |
|---------------------|-------------------------------------------------------|
| Short description | Potential collective Terminal Block, Screw Connection |
| Category | Potential collective Terminal Block |
| Pitch (mm) | 15.3 |
| Color | Beige (default) |
| Connection method | Screw Connection / Push-in Design |
| Type of locking | Rail Mounting |
| Length (mm) | 100 |
| Width (mm) | 15.3 |
| Height (mm) | 48.5 |
| Number of positions | ≥1P |
| Level | Single level |
| Connection points | 9 |

Material information

| | |
|---------------------------|----|
| Insulation material | PA |
| Insulation material group | I |

| | |
|----------------------------------------------|-------------------|
| Flame retardant rating , compliant with UL94 | V0 |
| Insulation resistance | □500MΩ at DC 500V |

Connection data-IEC

| | |
|---------------------------------------------------------------------------------------------------------|----------------------------------|
| Rated current (A) | Line Side: 57 / Load Side: 17.5 |
| Rated voltage (III/3)(V) | 1000 |
| Rated impulse voltage (III/3)(KV) | 8 |
| Conductor cross section solid. min (mm ²) | Line Side: 0.5 / Load Side: 0.14 |
| Conductor cross section solid.max (mm ²) | Line Side: 16 / Load Side: 1.5 |
| Conductor cross section stranded. min (mm ²) | Line Side: 0.5 / Load Side: 0.14 |
| Conductor cross section stranded. max (mm ²) | Line Side: 10 / Load Side: 1.5 |
| Conductor cross section flexible, with min ferrule without plastic sleeve (mm ²) | Line Side: 0.5 / Load Side: 0.25 |
| Conductor cross section flexible, with max ferrule without plastic sleeve (mm ²) | Line Side: 10 / Load Side: 1.5 |
| Conductor cross section flexible, with min ferrule with plastic sleeve (mm ²) | Line Side: 0.5 / Load Side: 0.25 |
| Conductor cross section flexible, with max ferrule with plastic sleeve (mm ²) | Line Side: 10 / Load Side: 0.75 |
| 2 conductors with same cross section flexible, min twin ferrules with plastic sleeve (mm ²) | Line Side: 1.5 |
| 2 conductors with same cross section flexible, max twin ferrules with plastic sleeve (mm ²) | Line Side: 4 |
| Slotted screwdriver size (Blade thickness x Width)(mm) | 0.4x2.5&1x5.5 |
| Stripping Length (mm) | Line Side: 17~18/ Load Side: 7~8 |
| Mounting rail | TS-35 |
| End cover plate required | NO |
| Grounding connections | NO |

Connection data-UL

| | |
|-------------------------------------------------|-------------------------------|
| Rated voltage (UL/CUL Group B)(V) | 600 |
| Rated current (UL/CUL Group B)(A) | Line Side: 50 / Load Side: 10 |
| Rated voltage (UL/CUL Group C)(V) | 600 |
| Rated current (UL/CUL Group C)(A) | Line Side: 50 / Load Side: 10 |
| Rated voltage (UL/CUL Group D)(V) | 600 |
| Rated current (UL/CUL Group D)(A) | Line Side: 5 / Load Side: 5 |
| Min. solid wire connection (AWG) acc. to UL/CUL | Line Side: 20 / Load Side: 26 |
| Max. solid wire connection AWG acc. to UL/CUL | Line Side: 6 / Load Side: 14 |

| | |
|--------------------------------------------------|-------------------------------|
| Min. stranded wire connection AWG acc. to UL/CUL | Line Side: 20 / Load Side: 26 |
| Max. stranded wire connection AWG acc. to UL/CUL | Line Side: 6 / Load Side: 14 |

Environment & Safety

| | |
|-----------------------------------------|-----|
| Back of the hand protection (YES or NO) | YES |
| Finger protection (YES or NO) | YES |
| Operating temperature. max (°C) | 120 |
| Operating temperature. min (°C) | -40 |

UL Recognized

| | |
|----------------------------|-------------------------------------|
| Wire Range (Group B)(AWG) | Line Side : 20~6 / Load Side: 26~14 |
| Rated voltage (Group B)(V) | 600 |
| Rated current (Group B)(A) | Line Side : 50 / Load Side: 10 |
| Wire Range (Group C)(AWG) | Line Side : 20~6 / Load Side: 26~14 |
| Rated voltage (Group C)(V) | 600 |
| Rated current (Group C)(A) | Line Side : 50 / Load Side: 10 |
| Wire Range (Group D)(AWG) | Line Side : 20~6 / Load Side: 26~14 |
| Rated voltage (Group D)(V) | 600 |
| Rated current (Group D)(A) | Line Side : 5 / Load Side: 5 |

CUL Recognized

| | |
|----------------------------|-------------------------------------|
| Wire Range (Group B)(AWG) | Line Side : 20~6 / Load Side: 26~14 |
| Rated voltage (Group B)(V) | 600 |
| Rated current (Group B)(A) | Line Side : 50 / Load Side: 10 |
| Wire Range (Group C)(AWG) | Line Side : 20~6 / Load Side: 26~14 |
| Rated voltage (Group C)(V) | 600 |
| Rated current (Group C)(A) | Line Side : 50 / Load Side: 10 |
| Wire Ranget (Group D)(AWG) | Line Side : 20~6 / Load Side: 26~14 |
| Rated voltage (Group D)(V) | 600 |
| Rated current (Group D)(A) | Line Side : 5 / Load Side: 5 |

Drawings

| | |
|--|--|
| | |
|--|--|

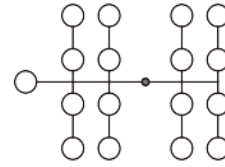
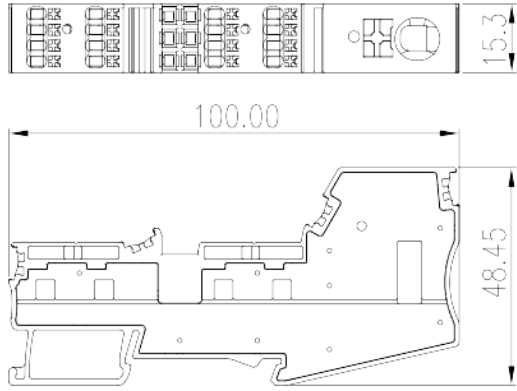

Approvals

