

EHK508R-XXP

PCB > PCB

:2026-05-14 :V1

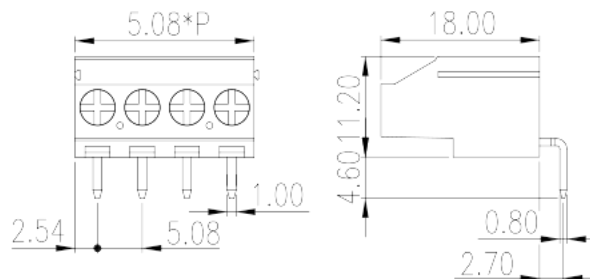

Pitch : 5.08mm, 300V, 25A

		PCB Terminal Blocks, Screw Connection
		PCB Terminal Blocks
(mm)		5.08
		Green (default)
		Screw Connection
		Without
(mm)		$5.08 * (P-1) + 5.08$
(mm)		18
(mm)		11.2
(x) (mm)		4.6
PCB	(mm)	1.6
()		02~24P
		Single level
		PA
		I
UL 94		V0



	500M at DC 500V
	COPPER ALLOY
	Tin PLATED

-IEC

(V)	320
(A)	25
(II/2)(V)	630
(III/2)(V)	320
(III/3)(V)	320
(II/2)(KV)	4
(III/2)(KV)	4
(III/3)(KV)	4
(mm ²)	0.5
(mm ²)	2.5
(mm ²)	0.5
(mm ²)	2.5
(mm ²) , ,	0.5
(mm ²) , ,	1.5
(mm ²) , ,	0.5
(mm ²) , ,	1.5
2 (mm ²)	0.5
2 (mm ²)	1.5
2 (mm ²)	0.5
2 (mm ²)	1.5
(mm ²) 2 , ,	0.5
(mm ²) 2 , ,	1
2 (mm ²) , ,	0.5
2 (mm ²) , ,	1
	M2.5



(N.m)	0.4
	7~8

-UL

(UL/CUL Group B)(V)	300
(UL/CUL Group B)(A)	25
(UL/CUL Group C)(V)	300
(UL/CUL Group C)(A)	25
(UL/CUL Group D)(V)	300
(UL/CUL Group D)(A)	10
UL/CUL AWG	24
UL/CUL AWG	12
UL/CUL AWG	24
UL/CUL AWG	12

&

가 (YES or NO)	YES
	120
	-40

UL

(Group B)(AWG)	24~12
(Group B)(V)	300
(Group B)(A)	25
(Group C)(AWG)	24~12
(Group C)(V)	300
(Group C)(A)	25

CUL

(Group B)(AWG)	24~12
(Group B)(V)	300
(Group B)(A)	25
(Group C)(AWG)	24~12
(Group C)(V)	300
(Group C)(A)	25

VDE

(mm ²)	0.5~2.5
(V)	250
(A)	24

