

0184-13XX

PCB > PCB -

:2026-07-05

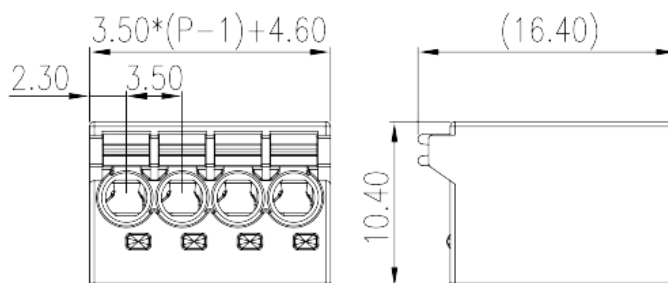

Pitch : 3.50 mm, 150V, 6A

	PCB Connector-Plug, Push-in Design
	PCB Connector – Plug
(mm)	3.50
	Black (default)
	Push in Design
	PCB Connection
(mm)	$3.50 * (P - 1) + 4.6$
(mm)	10.4
(mm)	16.4
()	02P~24P
	Single level
	PA
	I
UL 94	V0
	500M at DC 500V
	COPPER ALLOY

Tin PLATED

-IEC

(V)	320
(A)	7
(II/2)(V)	320
(III/2)(V)	125
(III/3)(V)	125
(II/2)(KV)	2.5
(III/2)(KV)	2.5
(III/3)(KV)	2.5
(mm ²)	0.2
(mm ²)	1.5
(mm ²)	0.2
(mm ²)	1.5
(mm ²) , ,	0.25
(mm ²) , ,	1
(mm ²) , ,	0.25
(mm ²) , ,	0.75
	8~9

-UL

(UL/CUL Group B)(V)	150
(UL/CUL Group B)(A)	6
UL/CUL AWG	24
UL/CUL AWG	16
UL/CUL AWG	24
UL/CUL AWG	16

&

가 (YES or NO)	YES
	120
	-40

