

PPAC-25MAS

PCB >

:2026-07-05

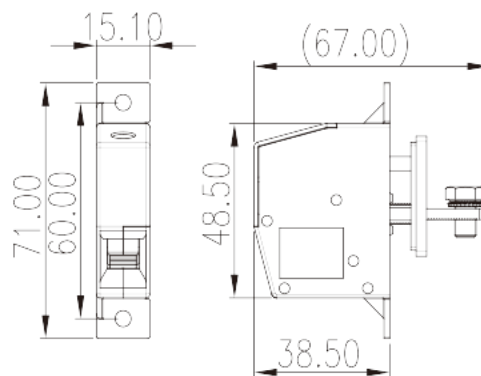

M5, 300V, 115A

	Panel Feed-Through, Screw Connection
	Panel Feed-Through
	Grey (default)
	Screw Connection
	With mounting flange
(mm)	15.1
(mm)	67
(mm)	71
()	1P
	PA
	I
UL 94	V0
	500M at DC 500V
	COPPER ALLOY
	Tin PLATED

-IEC

(V)	400
(A)	125
(III/3)(V)	400
(III/3)(KV)	8
(mm ²)	6
(mm ²)	35
(mm ²)	6
(mm ²)	25
(mm ²) , ,	6
(mm ²) , ,	25
(mm ²) , ,	6
(mm ²) , ,	16
2 (mm ²)	10
2 (mm ²)	10
(mm ²) ² , ,	2.5
(mm ²) ² , ,	10
(mm ²) ² , ,	2.5
(mm ²) ² , ,	10
Philips	M5
(N.m)	PZ2
(N.m)	2
(N.m)	3.38
	19

-UL

(UL/CUL Group B)(V)	300
(UL/CUL Group B)(A)	115
(UL/CUL Group D)(V)	300
(UL/CUL Group D)(A)	10



UL/CUL	AWG	8
UL/CUL	AWG	2
UL/CUL	AWG	8
UL/CUL	AWG	2

&

(YES or NO)	YES
가 (YES or NO)	YES
	120
	-40

UL

(Group B)(AWG)	8~2
(Group B)(V)	300
(Group B)(A)	115
(Group D)(AWG)	8~2
(Group D)(V)	300
(Group D)(A)	10

CUL

(Group B)(AWG)	8~2
(Group B)(V)	300
(Group B)(A)	115
(Group D)(AWG)	8~2
(Group D)(V)	300
(Group D)(A)	10

--	--

