

DKD35-P003

DIN

>

:2026-07-05

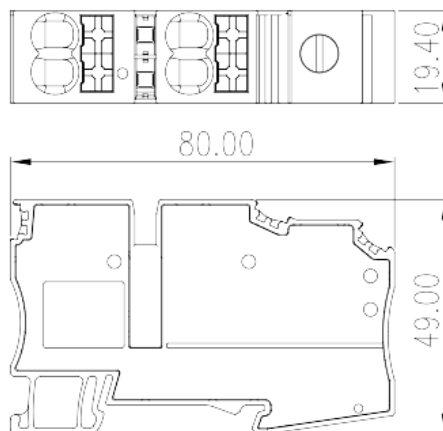
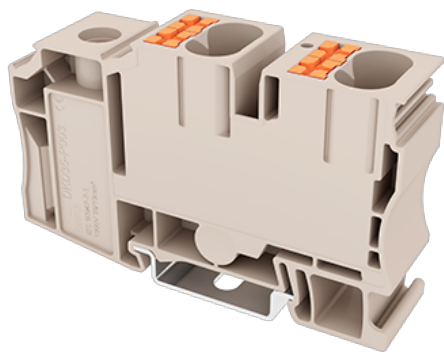

600V, 96A, Beige (default)

	Potential collective Terminal Block, Screw Connection / Push-in Design
	Potential collective Terminal Block
(mm)	19.4
	Beige (default)
	Screw Connection / Push-in Design
(mm)	80
(mm)	19.4
(mm)	49
()	1P
	Single level
	5
	PA
	I
UL 94	V0
	500M at DC 500V

-IEC

(V)		1000
(A)		Line Side: 105 / Load Side: 57
(III/3)(V)		1000
(III/3)(KV)		8
(mm ²)		Line Side: 1.5 / Load Side: 0.5
(mm ²)		Line Side: 50 / Load Side: 16
(mm ²)		Line Side: 1.5 / Load Side: 0.5
(mm ²)		Line Side: 35 / Load Side: 10
(mm ²)	,	Line Side: 1.5 / Load Side: 0.5
(mm ²)	,	Line Side: 35 / Load Side: 10
(mm ²)	,	Line Side: 1.5 / Load Side: 0.5
(mm ²)	,	Line Side: 35 / Load Side: 10
2	(mm ²)	Line Side: 1.5
2	(mm ²)	Line Side: 16
2	(mm ²)	Line Side: 1.5
2	(mm ²)	Line Side: 10
(mm ²)	2 ,	Line Side: 1.5
(mm ²)	2 ,	Line Side: 10
(mm ²)	2 ,	Line Side: 1.5 / Load Side: 1.5
(mm ²)	2 ,	Line Side: 10 / Load Side: 4
		Line Side:M6
Width)(mm)	(Blade thickness x	1X5.5
(N.m)		Line Side:4
(N.m)		Line Side:6
		Line Side: 12~13/ Load Side:17~18
		TS-35
		NO
		NO

**-UL**

(UL/CUL Group B)(V)		600
(UL/CUL Group B)(A)		96 (Line) 55 (Load)
(UL/CUL Group C)(V)		600
(UL/CUL Group C)(A)		96 (Line) 55 (Load)
(UL/CUL Group D)(V)		600
(UL/CUL Group D)(A)		5
UL/CUL	AWG	12 (Line Side) 20 (Load Side)
UL/CUL	AWG	1/0 (Line Side) 6 (Load Side)
UL/CUL	AWG	12 (Line Side) 20 (Load Side)
UL/CUL	AWG	1/0 (Line Side) 6 (Load Side)

&

(YES or NO)		YES
가 (YES or NO)		NO
		120
		-40

UL

(Group B)(AWG)		Line Side : 12~1/0 / Load Side : 20~6
(Group B)(V)		600
(Group B)(A)		Line Side : 96 / Load Side : 55
(Group C)(AWG)		Line Side : 12~1/0 / Load Side : 20~6
(Group C)(V)		600
(Group C)(A)		Line Side : 96 / Load Side : 55
(Group D)(AWG)		Line Side : 12~1/0 / Load Side : 20~6
(Group D)(V)		600
(Group D)(A)		5

CUL

(Group B)(AWG)		Line Side : 12~1/0 / Load Side : 20~6
(Group B)(V)		600
(Group B)(A)		Line Side : 96 / Load Side : 55
(Group C)(AWG)		Line Side : 12~1/0 / Load Side : 20~6

(Group C)(V)	600
(Group C)(A)	Line Side : 96 / Load Side : 55
(Group D)(AWG)	Line Side : 12~1/0 / Load Side : 20~6
(Group D)(V)	600
(Group D)(A)	5

