

DP2.5N-CP

DIN

>

:2026-05-14

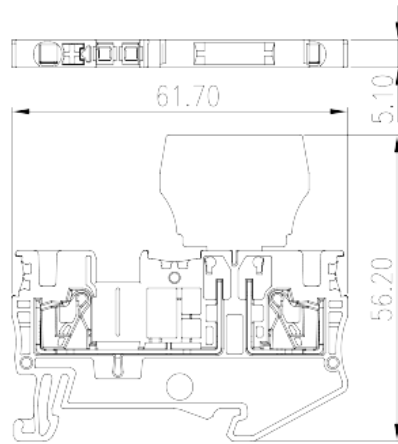
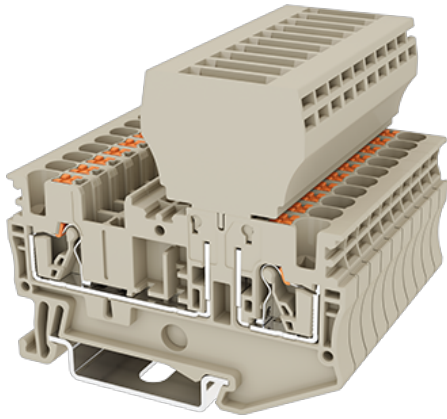

300V, 6A, Beige (default)

	Disconnect Terminal Block, Push-in Design
	Disconnect Terminal Block
	Beige (default)
	Push-in Design
	Rail Mounting
(mm)	61.7
(mm)	5.1
(mm)	56.2
()	1P
	Single level
	2
	PA
	I
UL 94	V0
	500M at DC 500V

-IEC

(V)	400
(A)	6
(III/3)(V)	400
(III/3)(KV)	6
(mm ²)	0.14
(mm ²)	4
(mm ²)	0.14
(mm ²)	2.5
(mm ²) , ,	0.25
(mm ²) , ,	2.5
(mm ²) , ,	0.25
(mm ²) , ,	2.5
² (mm ²) , ,	0.5
² (mm ²) , ,	0.5
Width)(mm) (Blade thickness x	0.6x3.5
	10
	TS-35
	YES
	NO

-UL

(UL/CUL Group B)(V)	300
(UL/CUL Group B)(A)	6
(UL/CUL Group C)(V)	300
(UL/CUL Group C)(A)	6
UL/CUL AWG	26
UL/CUL AWG	12
UL/CUL AWG	26
UL/CUL AWG	12

&

(YES or NO)	YES
가 (YES or NO)	YES
	120
	-40

UL

(Group B)(AWG)	26~12
(Group B)(V)	300
(Group B)(A)	6
(Group C)(AWG)	26~12
(Group C)(V)	300
(Group C)(A)	6

CUL

(Group B)(AWG)	26~12
(Group B)(V)	300
(Group B)(A)	6
(Group C)(AWG)	26~12
(Group C)(V)	300
(Group C)(A)	6

