

ESC350VK-XXP

PCB > PCB -

:2026-07-04

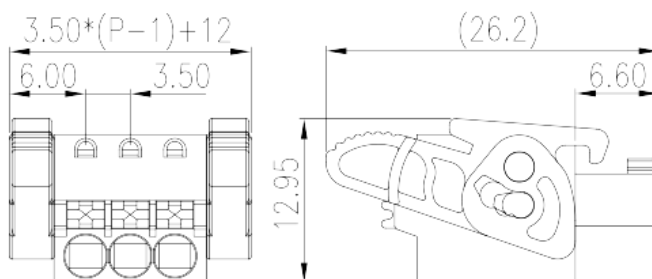
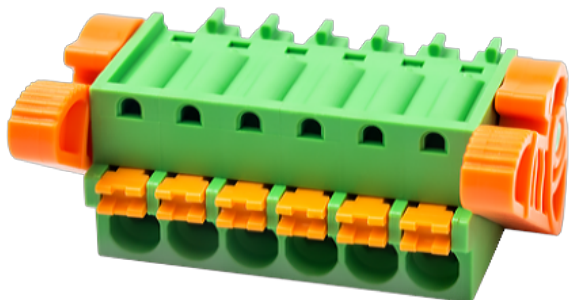

Pitch: 3.50mm, 300V, 8A

	PCB Connector-Plug, Push-in Design
	PCB Connector – Plug
(mm)	3.50
	Green (default)
	Push in Design
	With release tool
(mm)	$3.50 * (P-1) + 12$
(mm)	12.5
(mm)	26
()	02P~24P
	Single level

	PA
	I
UL 94	V0
	500M at DC 500V
	COPPER ALLOY



Tin PLATED

-IEC

(V)	630
(A)	10
(II/2)(V)	630
(III/2)(V)	320
(III/3)(V)	250
(II/2)(KV)	4
(III/2)(KV)	4
(III/3)(KV)	4
(mm ²)	0.2
(mm ²)	1.5
(mm ²)	0.2
(mm ²)	1.5
(mm ²) , ,	0.25
(mm ²) , ,	1.5
(mm ²) , ,	0.25
(mm ²) , ,	0.75
Width)(mm) (Blade thickness x	0.4x2.5
	8~9

-UL

(UL/CUL Group B)(V)	300
(UL/CUL Group B)(A)	8
(UL/CUL Group D)(V)	300
(UL/CUL Group D)(A)	8
UL/CUL AWG	28
UL/CUL AWG	16
UL/CUL AWG	28
UL/CUL AWG	16

&

가 (YES or NO)	YES
	120
	-40

