

# DP6N-TFLXXS

DIN

>

:2025-05-02

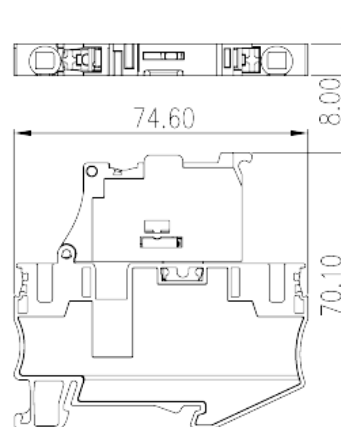
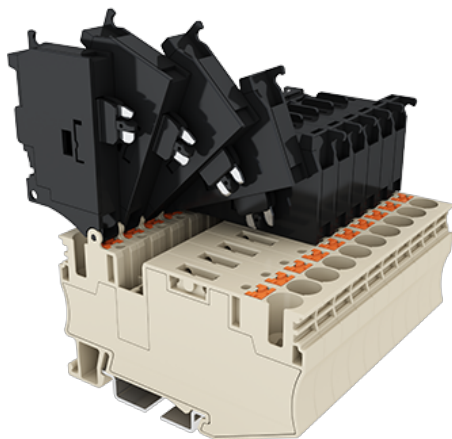

300V, 10A, Beige (default)

	Fuse Terminal Block, Push-in Design
	Fuse Terminal Block
	Refer to drawing
	Push-in Design
(mm)	74.59999999999999
(mm)	8
(mm)	71.6(TS-35N)/79.1(TS-35/15N)
	Single level
	2
	PA
	I
UL 94	V0
	500M at DC 500V
	HIGH PERFORMANCE COPPER ALLOY
	Tin PLATED

**-IEC**

(V)	630 (the Voltage is determined by the selected LED )
(III/3)(V)	630
(III/3)(KV)	6
(mm <sup>2</sup> )	0.5
(mm <sup>2</sup> )	10
(mm <sup>2</sup> )	0.5
(mm <sup>2</sup> )	6
(mm <sup>2</sup> ) , ,	0.5
(mm <sup>2</sup> ) , ,	6
(mm <sup>2</sup> ) , ,	0.5
(mm <sup>2</sup> ) , ,	6
2 (mm <sup>2</sup> ) , ,	0.5
2 (mm <sup>2</sup> ) , ,	1.5
Width)(mm) (Blade thickness x	0.8x4
	12
	TS-35N、 TS-35/15N
	YES
	NO

**-UL**

(UL/CUL Group B)(V)	300
(UL/CUL Group B)(A)	10
(UL/CUL Group C)(V)	300
(UL/CUL Group C)(A)	10
UL/CUL AWG	20
UL/CUL AWG	8
UL/CUL AWG	20
UL/CUL AWG	8

&

(YES or NO)	YES
가 (YES or NO)	YES
	120
	-40

