

# DPH10-DP-PE

DIN

>

:2026-07-05

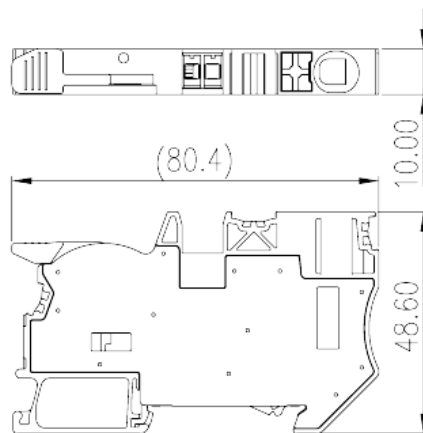
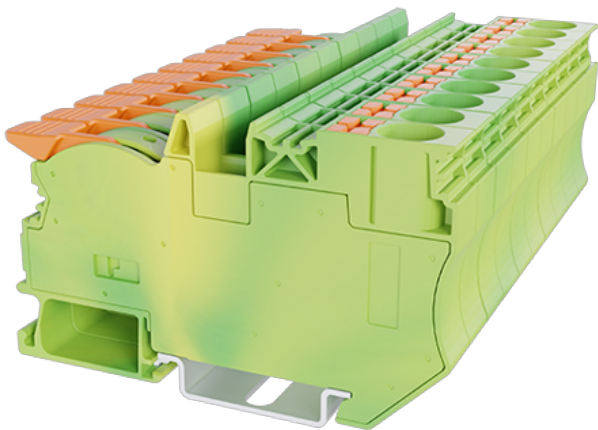

600V, Yellow-Green (default)

	Grounding Terminal Block, Push-in Design
	Grounding Terminal Block
	Refer to drawing
	Push-in Design
	Rail Mounting
(mm)	80.4
(mm)	10
(mm)	50.1 ( TS-35N ) / 57.6 ( TS-35/15N )
( )	1P
	Single level
	2
	PA
	I
UL 94	V0
	500M at DC 500V

**-IEC**

(V)		1000
(III/3)(V)		1000
(III/3)(KV)		8
(mm <sup>2</sup> )		0.5
(mm <sup>2</sup> )		16
(mm <sup>2</sup> )		0.5
(mm <sup>2</sup> )		10
(mm <sup>2</sup> )	,	0.5
(mm <sup>2</sup> )	,	10
(mm <sup>2</sup> )	,	0.5
(mm <sup>2</sup> )	,	10
<sup>2</sup> (mm <sup>2</sup> )	,	1.5
<sup>2</sup> (mm <sup>2</sup> )	,	4
Width)(mm)	(Blade thickness x	1x5.5
		18~20
		TS-35N、TS-35/15N
		NO
		YES

**-UL**

(UL/CUL Group B)(V)		600
(UL/CUL Group C)(V)		600
(UL/CUL Group D)(V)		600
UL/CUL	AWG	20
UL/CUL	AWG	6
UL/CUL	AWG	20
UL/CUL	AWG	6

**&**

(YES or NO)		YES
-------------	--	-----

가 (YES or NO)	YES
	120
	-40

**UL**

(Group B)(AWG)	20~6
(Group B)(V)	600
(Group C)(AWG)	20~6
(Group C)(V)	600
(Group D)(AWG)	20~6
(Group D)(V)	600

**CUL**

(Group B)(AWG)	20~6
(Group B)(V)	600
(Group C)(AWG)	20~6
(Group C)(V)	600
(Group D)(AWG)	20~6
(Group D)(V)	600

