

DKB30N-XXPK

NEMA

>

:2026-07-05

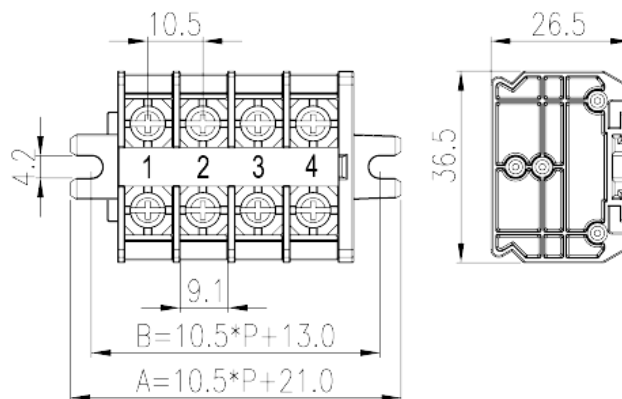

Pitch : 10.50mm, M4, 600V, 30/40A

	Panel Mounting, Screw Connection
	Panel Mounting
(mm)	10.5
	Refer to drawing
	Screw Connection
(mm)	$10.50 * P + 21$
(mm)	36.5
(mm)	26.5
()	01P~16P
	Single level
	2~32
	PC
	a
UL 94	V2
	1000M at DC 500V
	COPPER ALLOY

		Tin PLATED
-IEC		
(V)		630
(A)		32
(III/3)(V)		630
(III/3)(KV)		8
(mm ²)		0.34
(mm ²)		4
(mm ²)		0.34
(mm ²)		4
2	(mm ²)	4
2	(mm ²)	4
		M4
Philips		PH2
(N.m)		1.2~1.5
(N.m)		1.2
(N.m)		1.5
(N.m)		0.8
		12~13 The stripping length depends on the specification provided by the cable lug manufacturer
		TS-35N、TS-35/15N
		YES
		NO
-UL		
(UL/CUL Group B)(V)		600
(UL/CUL Group B)(A)		30
(UL/CUL Group C)(V)		600
(UL/CUL Group C)(A)		30
(UL/CUL Group D)(V)		600
(UL/CUL Group D)(A)		30
UL/CUL	AWG	22
UL/CUL	AWG	10
UL/CUL	AWG	22



UL/CUL	AWG	10
&		
	(YES or NO)	YES
가	(YES or NO)	NO
		125
		-40

UL

	(Group B)(AWG)	22-10/(2)22-(2)12
	(Group B)(V)	600
	(Group B)(A)	30/40
	(Group C)(AWG)	22-10/(2)22-(2)12
	(Group C)(V)	600
	(Group C)(A)	30/40
	(Group D)(AWG)	22-10/(2)22-(2)12
	(Group D)(V)	600
	(Group D)(A)	5

CUL

	(Group B)(AWG)	22-10/(2)22-(2)12
	(Group B)(V)	600
	(Group B)(A)	30/40
	(Group C)(AWG)	22-10/(2)22-(2)12
	(Group C)(V)	600
	(Group C)(A)	30/40
	(Group D)(AWG)	22-10/(2)22-(2)12
	(Group D)(V)	600
	(Group D)(A)	5

--	--	--

