

# DKB300-XXPCK

NEMA

>

:2026-07-04

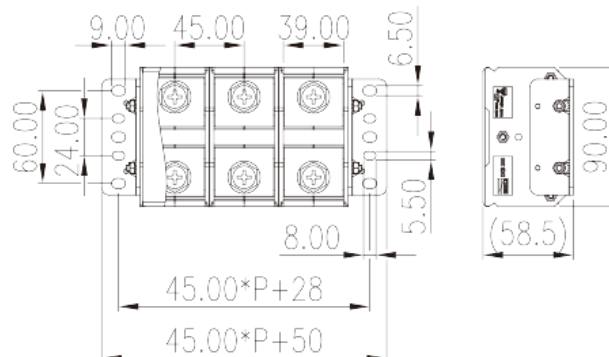

Pitch : 45.00mm, M10, 600V, 380A

	Panel Mounting, Screw Connection
	Panel Mounting
(mm)	45.00
	Refer to drawing
	Screw connection
	Panel Mounting
(mm)	45*P+50
(mm)	90
(mm)	Refer to drawing
( )	01P~12P
	Single level
	2~24
	PC
	IIIa
UL 94	V2
	1000M at DC 500V



	COPPER ALLOY
	Ni PLATED

**-IEC**

(V)	1000
(A)	415
(III/3)(V)	800
(III/3)(KV)	8
	M10
Philips	PH4
(N.m)	10
	The stripping length depends on the specification provided by the cable lug manufacturer
	NO

**-UL**

(UL/CUL Group B)(V)	600
(UL/CUL Group B)(A)	380
(UL/CUL Group C)(V)	600
(UL/CUL Group C)(A)	380
UL/CUL                      AWG	3/0
UL/CUL                      AWG	500Kcmil
UL/CUL                      AWG	3/0
UL/CUL                      AWG	500Kcmil

**&**

(YES or NO)	YES
가 (YES or NO)	NO
	125
	-40

**UL**

(Group B)(AWG)	3/0~500kcmil 2x(6~3/0)
(Group B)(V)	600
(Group B)(A)	380

(Group C) (AWG)	3/0~500kcmil 2x(6~3/0)
(Group C) (V)	600
(Group C) (A)	380

### CUL

(Group B) (AWG)	3/0~500kcmil 2x(6~3/0)
(Group B) (V)	600
(Group B) (A)	380
(Group C) (AWG)	3/0~500kcmil 2x(6~3/0)
(Group C) (V)	600
(Group C) (A)	380

### VDE

(mm <sup>2</sup> )	70~240
(V)	1000
(A)	415

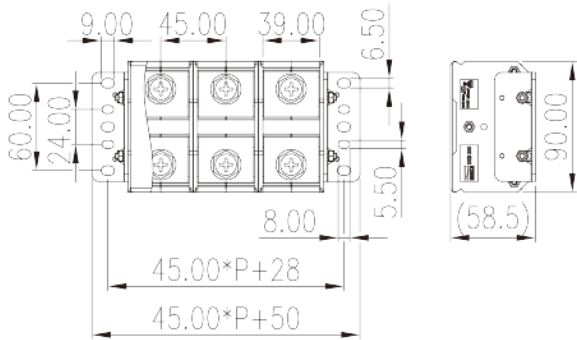



Delight Through Connections