

DT-49-C91W-XX

>

:2026-07-05 :1.1

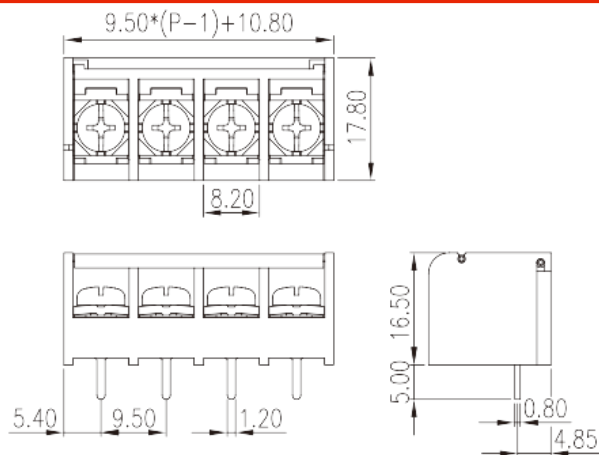
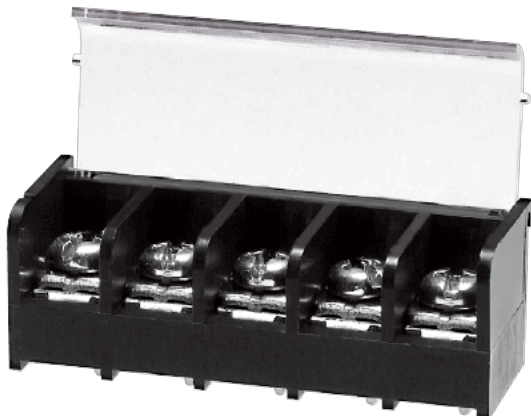

Pitch: 9.50mm , M3.5, 300V, 25A

	Barrier terminal blocks , Screw connection
	Single Row
(mm)	9.50
	Black(default)
	Screw connection
	Without
(x) (mm)	0.8X1.2
PCB (mm)	1.5
	Single Row
	PA66
	I
UL 94	V0
	Copper Alloy
	Tinned

-IEC

(V)		1000
(A)		24
(II/2)(V)		1000
(III/2)(V)		630
(III/3)(V)		630
(II/2)(KV)		6
(III/2)(KV)		6
(III/3)(KV)		6
(mm ²)		0.5
(mm ²)		4
(mm ²)		0.5
(mm ²)		2.5
2	(mm ²)	2.5
2	(mm ²)	2.5
		M3.5
Width)(mm)	(Blade thickness x	0.8x4
Philips		PH2
	(N.m)	0.8
	(N.m)	1
		12~13

-UL

(UL/CUL Group B)(V)		300
(UL/CUL Group B)(A)		25
(UL/CUL Group D)(V)		300
(UL/CUL Group D)(A)		10
UL/CUL	AWG	22
UL/CUL	AWG	12
UL/CUL	AWG	22
UL/CUL	AWG	12

&

(YES or NO)		YES
		120

-40

UL

(Group B) (AWG)	22~12
(Group B) (V)	300
(Group B) (A)	25
(Group D) (AWG)	22~12
(Group D) (V)	300
(Group D) (A)	10

CUL

(Group B) (AWG)	22~12
(Group B) (V)	300
(Group B) (A)	25
(Group D) (AWG)	22~12
(Group D) (V)	300
(Group D) (A)	10

VDE

(mm ²)	0.5~4(sol) 0.5~2.5(str)
(V)	1000
(A)	24

