

# 0168-14XX

>

:2026-07-04 :1.1

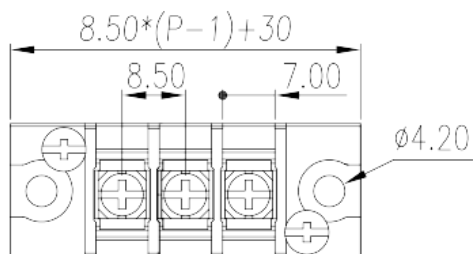
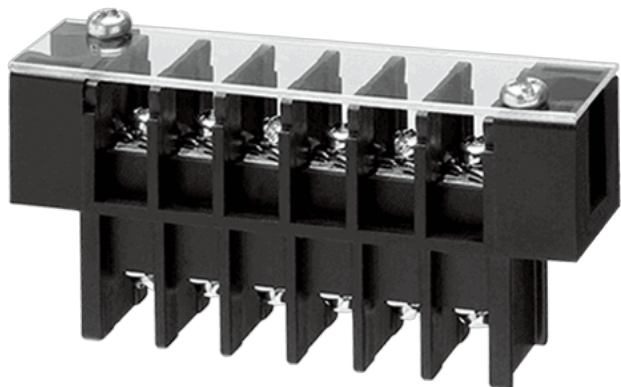

Pitch: 8.5mm , M3, 300V, 20A

	Barrier terminal blocks , Screw connection
	Panel Feed Through Terminal Blocks
(mm)	8.5
	Black(default)
	Screw connection
	With mounting flange
	Single level
	PBT
	IIIa
UL 94	V0
	Copper Alloy
	Tinned
	<b>-IEC</b>
(A)	32
(II/2)(V)	630



(III/2)(V)		600
(III/3)(V)		400
(II/2)(KV)		6
(III/2)(KV)		6
(III/3)(KV)		6
(mm <sup>2</sup> )		0.34
(mm <sup>2</sup> )		4
(mm <sup>2</sup> )		0.34
(mm <sup>2</sup> )		4
2	(mm <sup>2</sup> )	4
2	(mm <sup>2</sup> )	4
		M3
Width)(mm)	(Blade thickness x	0.8x4.0
Philips		PH2
(N.m)		1
(N.m)		0.5
(N.m)		1
		8~9

**-UL**

(UL/CUL Group B)(V)		300
(UL/CUL Group B)(A)		20
UL/CUL	AWG	22
UL/CUL	AWG	12
UL/CUL	AWG	22
UL/CUL	AWG	12

**&**

(YES or NO)		YES
		130
		-40

**UL**

(Group B)(AWG)		22~12
----------------	--	-------

(Group B)(V)	300
(Group B)(A)	20

**CUL**

(Group B)(AWG)	22~12
(Group B)(V)	300
(Group B)(A)	20

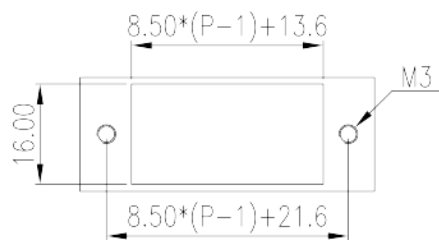
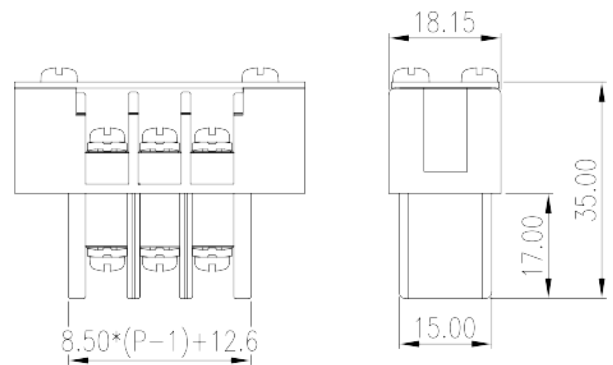
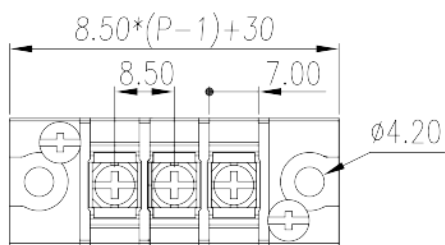



Delight Through Connections