

# P-810N

>

:2026-07-04

:1.2

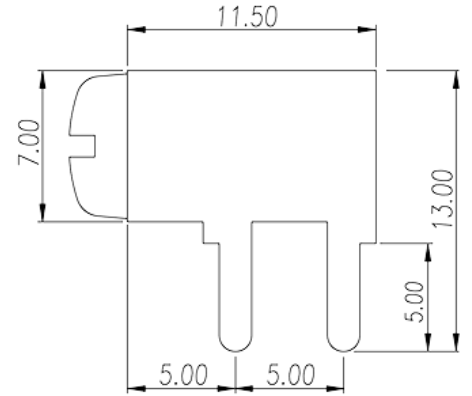
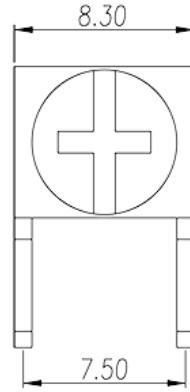
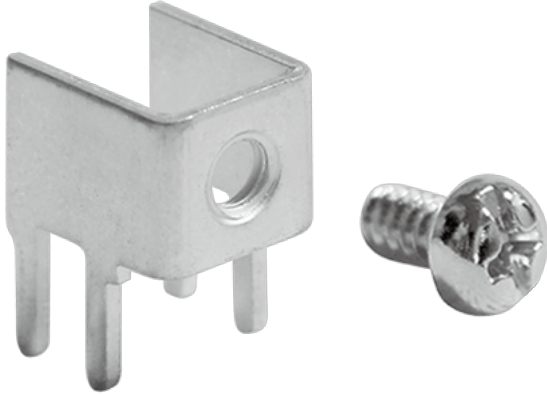

Pin size:0.8x1.5mm, 80A

	Barrier terminal blocks, Quick terminal blocks
	Quick terminal blocks
(    x    ) (mm)	0.8x1.5

	COPPER ALLOY
	Tin PLATED

## -IEC

(A)	80
	#6-32
Width)(mm)                      (Blade thickness x	0.8x4.0
Phillips	PH2
(N.m)	0.8
(N.m)	1

