

P-830

>

:2026-07-04 :1.2

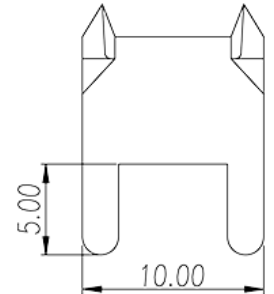
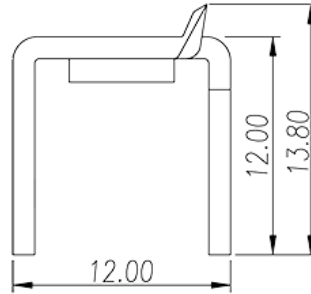

Pitch : 8.00 /10.80 mm, 1.2x2.0mm, 85A

	Barrier terminal blocks, Quick terminal blocks
	Quick terminal blocks
(mm)	8.00 / 10.80
(x) (mm)	1.2x2.0
	COPPER ALLOY
	Tin PLATED
-IEC	
(A)	85
	M5

