

DPD10-P001

DIN Rail Terminal Blocks > Push-in Design

Date:2026-01-31

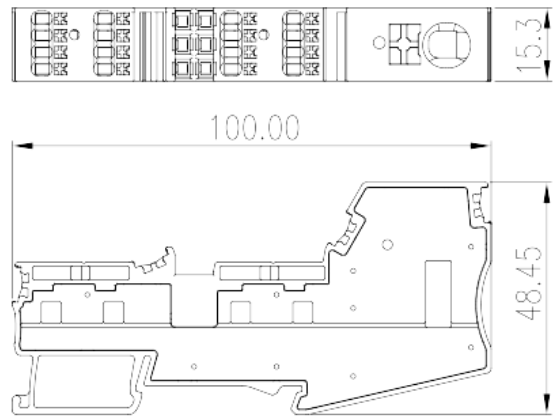
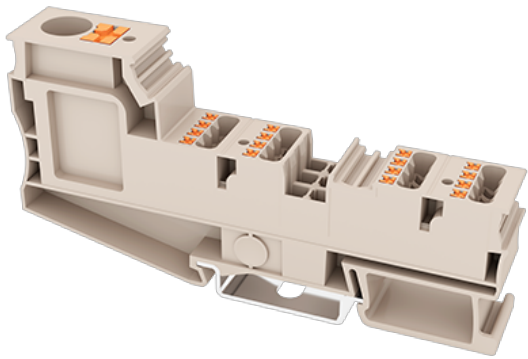

The web catalog is for reference only. Dinkle remains the right of product modification and engineering change of the design.
The final product is made according to engineering drawing.

Product Description

600V, 50A, Beige (default)

General information

Short description	Potential collective Terminal Block, Screw Connection
Category	Potential collective Terminal Block
Pitch (mm)	15.3
Color	Beige (default)
Connection method	Screw Connection / Push-in Design
Length (mm)	100
Width (mm)	15.3
Height (mm)	48.5
Level	Single level
Connection points	9

Material information

Insulation material	PA
Insulation material group	I
Flame retardant rating , compliant with UL94	V0
Insulation resistance	□500MΩ at DC 500V

Connection data-IEC

Rated current (A)	Line Side: 57 / Load Side: 17.5
Rated voltage (III/3)(V)	1000
Rated impulse voltage (III/3)(KV)	8
Conductor cross section solid. min (mm ²)	Line Side: 0.5 / Load Side: 0.14
Conductor cross section solid.max (mm ²)	Line Side: 16 / Load Side: 1.5
Conductor cross section stranded. min (mm ²)	Line Side: 0.5 / Load Side: 0.14
Conductor cross section stranded. max (mm ²)	Line Side: 10 / Load Side: 1.5
Conductor cross section flexible, with min ferrule without plastic sleeve (mm ²)	Line Side: 0.5 / Load Side: 0.25
Conductor cross section flexible, with max ferrule without plastic sleeve (mm ²)	Line Side: 10 / Load Side: 1.5
Conductor cross section flexible, with min ferrule with plastic sleeve (mm ²)	Line Side: 0.5 / Load Side: 0.25
Conductor cross section flexible, with max ferrule with plastic sleeve (mm ²)	Line Side: 10 / Load Side: 0.75
Mounting rail	TS-35

Connection data-UL

Rated voltage (UL/CUL Group B)(V)	600
Rated current (UL/CUL Group B)(A)	Line Side: 50 / Load Side: 10
Rated voltage (UL/CUL Group C)(V)	600
Rated current (UL/CUL Group C)(A)	Line Side: 50 / Load Side: 10
Rated voltage (UL/CUL Group D)(V)	600
Rated current (UL/CUL Group D)(A)	Line Side: 5 / Load Side: 5
Min. solid wire connection (AWG) acc. to UL/CUL	Line Side: 20 / Load Side: 26
Max. solid wire connection AWG acc. to UL/CUL	Line Side: 6 / Load Side: 14
Min. stranded wire connection AWG acc. to UL/CUL	Line Side: 20 / Load Side: 26
Max. stranded wire connection AWG acc. to UL/CUL	Line Side: 6 / Load Side: 14

Environment & Safety

Back of the hand protection (YES or NO)	YES
Finger protection (YES or NO)	YES
Operating temperature. max (°C)	120
Operating temperature. min (°C)	-40

UL Recognized

Wire Range (Group B)(AWG)	Line Side : 20~6 / Load Side: 26~14
Rated voltage (Group B)(V)	600
Rated current (Group B)(A)	Line Side : 50 / Load Side: 10
Wire Range (Group C)(AWG)	Line Side : 20~6 / Load Side: 26~14
Rated voltage (Group C)(V)	600
Rated current (Group C)(A)	Line Side : 50 / Load Side: 10
Wire Range (Group D)(AWG)	Line Side : 20~6 / Load Side: 26~14
Rated voltage (Group D)(V)	600
Rated current (Group D)(A)	Line Side : 5 / Load Side: 5

CUL Recognized

Wire Range (Group B)(AWG)	Line Side : 20~6 / Load Side: 26~14
Rated voltage (Group B)(V)	600
Rated current (Group B)(A)	Line Side : 50 / Load Side: 10
Wire Range (Group C)(AWG)	Line Side : 20~6 / Load Side: 26~14
Rated voltage (Group C)(V)	600
Rated current (Group C)(A)	Line Side : 50 / Load Side: 10
Wire Ranget (Group D)(AWG)	Line Side : 20~6 / Load Side: 26~14
Rated voltage (Group D)(V)	600
Rated current (Group D)(A)	Line Side : 5 / Load Side: 5

Drawings

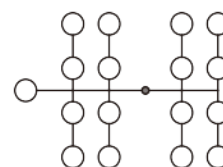
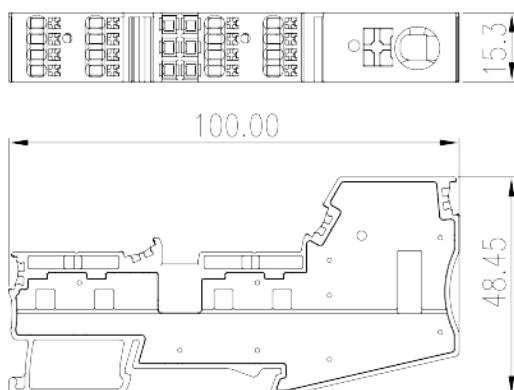

Approvals

