

DKD35-P001

DIN Rail Terminal Blocks > Push-in Design

Date:2026-05-09

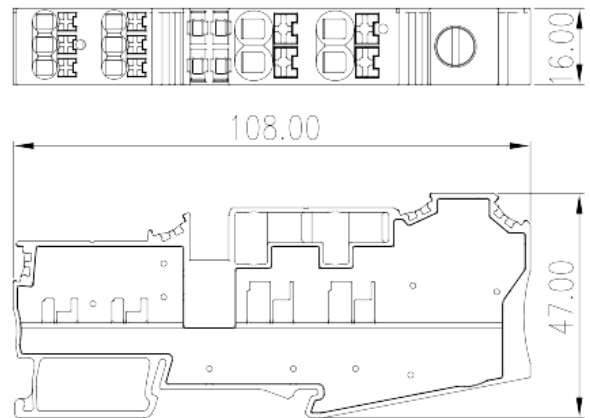
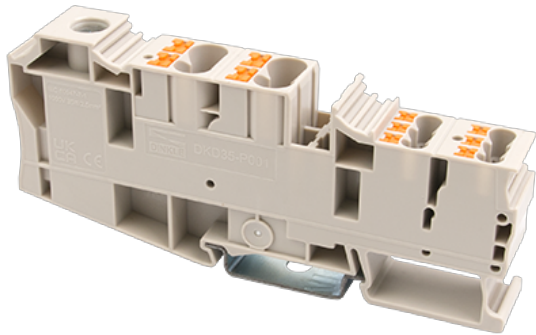

The web catalog is for reference only. Dinkle remains the right of product modification and engineering change of the design. The final product is made according to engineering drawing.

Product Description

600V, 102A, Beige (default)

General information

Short description	Potential collective Terminal Block, Screw Connection / Push-in Design
Category	Potential collective Terminal Block
Color	Beige (default)
Connection method	Screw Connection / Push-in Design
Length (mm)	108
Width (mm)	16
Height (mm)	47
Number of positions	≥1P
Level	Single level
Connection points	11

Material information

Insulation material	PA
Insulation material group	I
Flame retardant rating , compliant with UL94	V0

Insulation resistance	□500MΩ at DC 500V
-----------------------	-------------------

Connection data-IEC

Rated voltage (V)	1000
Rated current (A)	Line Side: 105 / Load Side1: 41 / Load Side2: 24
Rated voltage (III/3)(V)	1000
Rated impulse voltage (III/3)(KV)	8
Conductor cross section solid. min (mm ²)	Line Side: 1.5 / Load Side1: 0.5 / Load Side2: 0.2
Conductor cross section solid.max (mm ²)	Line Side: 50 / Load Side1: 10 / Load Side2: 4
Conductor cross section stranded. min (mm ²)	Line Side: 1.5 / Load Side1: 0.5 / Load Side2: 0.2
Conductor cross section stranded. max (mm ²)	Line Side: 35 / Load Side1: 6 / Load Side2: 2.5
Conductor cross section flexible, with min ferrule without plastic sleeve (mm ²)	Line Side: 1.5 / Load Side1: 0.5 / Load Side2: 0.25
Conductor cross section flexible, with max ferrule without plastic sleeve (mm ²)	Line Side: 35 / Load Side1: 6 / Load Side2: 2.5
Conductor cross section flexible, with min ferrule with plastic sleeve (mm ²)	Line Side: 1.5 / Load Side1: 0.5 / Load Side2: 0.25
Conductor cross section flexible, with max ferrule with plastic sleeve (mm ²)	Line Side: 35 / Load Side1: 6 / Load Side2: 2.5
2 conductors with same cross section, solid, min (mm ²)	1.5
2 conductors with same cross section, solid, max (mm ²)	16
2 conductors with same cross section, stranded, min (mm ²)	1.5
2 conductors with same cross section, stranded, max (mm ²)	10
2 conductors with same cross section flexible, with min ferrule without plastic sleeve (mm ²)	1.5
2 conductors with same cross section flexible, with max ferrule without plastic sleeve (mm ²)	10
2 conductors with same cross section flexible, min twin ferrules with plastic sleeve (mm ²)	Line Side: 1.5 / Load Side1: 0.5 / Load Side2: 0.5
2 conductors with same cross section flexible, max twin ferrules with plastic sleeve (mm ²)	Line Side: 10 / Load Side1: 1.5 / Load Side2: 0.5
Screw thread	M6
Philips screwdriver size	0.6X3.5 / 0.8X4 / 1X5.5
Recommend tightening torque. min (N.m)	4
Recommend tightening torque. max (N.m)	6
Stripping Length (mm)	Line Side: 14~16/ Load Side1: 11~12 / Load Side2:9~10
Mounting rail	TS-35

End cover plate required	NO
Grounding connections	NO

Connection data-UL

Rated voltage (UL/CUL Group B)(V)	600
Rated current (UL/CUL Group B)(A)	102 (Line Side) 40 (Load Side 1) 20 (Load Side 2)
Rated voltage (UL/CUL Group C)(V)	600
Rated current (UL/CUL Group C)(A)	102 (Line Side) 40 (Load Side 1) 20 (Load Side 2)
Rated voltage (UL/CUL Group D)(V)	600
Rated current (UL/CUL Group D)(A)	5
Min. solid wire connection (AWG) acc. to UL/CUL	Line Side: 12 / Load Side1: 20 / Load Side2: 26
Max. solid wire connection AWG acc. to UL/CUL	Line Side: 1/0 / Load Side1: 8 / Load Side2: 12
Min. stranded wire connection AWG acc. to UL/CUL	Line Side: 12 / Load Side1: 20 / Load Side2: 26
Max. stranded wire connection AWG acc. to UL/CUL	Line Side: 1/0 / Load Side1: 8 / Load Side2: 12

Environment & Safety

Back of the hand protection (YES or NO)	YES
Finger protection (YES or NO)	NO
Operating temperature. max (°C)	120
Operating temperature. min (°C)	-40

UL Recognized

Wire Range (Group B)(AWG)	Line Side : 12~1/0 / Load Side1: 20~8 / Load Side2: 26~12
Rated voltage (Group B)(V)	600
Rated current (Group B)(A)	Line Side : 102 / Load Side1: 40 / Load Side2: 20
Wire Range (Group C)(AWG)	Line Side : 12~1/0 / Load Side1: 20~8 / Load Side2: 26~12
Rated voltage (Group C)(V)	600
Rated current (Group C)(A)	Line Side : 102 / Load Side1: 40 / Load Side2: 20
Wire Range (Group D)(AWG)	Line Side : 12~1/0 / Load Side1: 20~8 / Load Side2: 26~12
Rated voltage (Group D)(V)	600
Rated current (Group D)(A)	5

CUL Recognized

--	--

	26~12
Wire Range (Group B)(AWG)	Line Side : 12~1/0 / Load Side1: 20~8 / Load Side2: 26~12
Rated current (Group B)(A)	Line Side : 102 / Load Side1: 40 / Load Side2: 20
Wire Range (Group C)(AWG)	Line Side : 12~1/0 / Load Side1: 20~8 / Load Side2: 26~12
Rated voltage (Group C)(V)	600
Rated current (Group C)(A)	Line Side : 102 / Load Side1: 40 / Load Side2: 20
Wire Ranget (Group D)(AWG)	Line Side : 12~1/0 / Load Side1: 20~8 / Load Side2: 26~12
Rated voltage (Group D)(V)	600
Rated current (Group D)(A)	5

Drawings

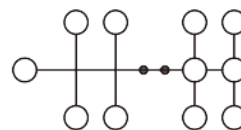
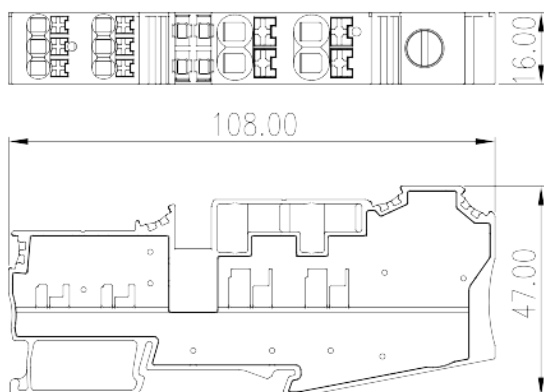

Approvals

