

DKD35-P003

DIN Rail Terminal Blocks > Push-in Design

Date:2026-01-31

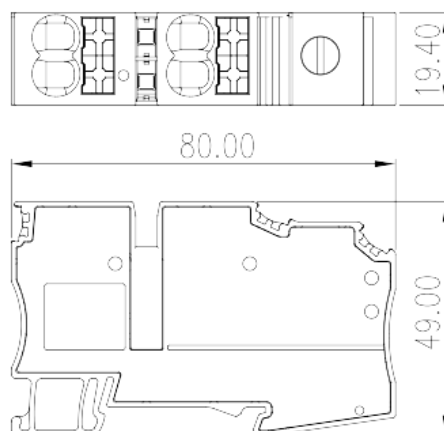
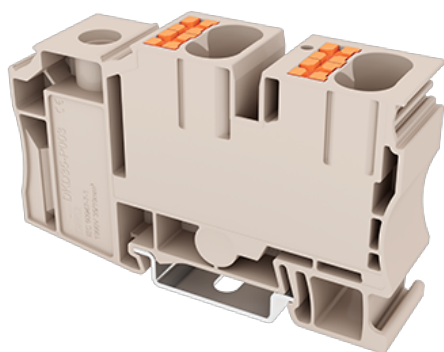

The web catalog is for reference only. Dinkle remains the right of product modification and engineering change of the design.
The final product is made according to engineering drawing.

Product Description

600V, 96A, Beige (default)

General information

Short description	Potential collective Terminal Block, Screw Connection / Push-in Design
Category	Potential collective Terminal Block
Pitch (mm)	19.4
Color	Beige (default)
Connection method	Screw Connection / Push-in Design
Length (mm)	80
Width (mm)	19.4
Height (mm)	49
Level	Single level
Connection points	5

Material information

Insulation material	PA
Insulation material group	I
Flame retardant rating , compliant with UL94	V0

Insulation resistance	□500MΩ at DC 500V
-----------------------	-------------------

Connection data-IEC

Mounting rail	TS-35
---------------	-------

Connection data-UL

Rated voltage (UL/CUL Group B)(V)	600
Rated current (UL/CUL Group B)(A)	96 (Line) 55 (Load)
Rated voltage (UL/CUL Group C)(V)	600
Rated current (UL/CUL Group C)(A)	96 (Line) 55 (Load)
Rated voltage (UL/CUL Group D)(V)	600
Rated current (UL/CUL Group D)(A)	5

UL Recognized

Wire Range (Group B)(AWG)	Line Side : 12~1/0 / Load Side : 20~6
Rated voltage (Group B)(V)	600
Rated current (Group B)(A)	Line Side : 96 / Load Side : 55
Wire Range (Group C)(AWG)	Line Side : 12~1/0 / Load Side : 20~6
Rated voltage (Group C)(V)	600
Rated current (Group C)(A)	Line Side : 96 / Load Side : 55
Wire Range (Group D)(AWG)	Line Side : 12~1/0 / Load Side : 20~6
Rated voltage (Group D)(V)	600
Rated current (Group D)(A)	Line Side : 96 / Load Side : 55

CUL Recognized

Wire Range (Group B)(AWG)	Line Side : 12~1/0 / Load Side : 20~6
Rated voltage (Group B)(V)	600
Rated current (Group B)(A)	Line Side : 96 / Load Side : 55
Wire Range (Group C)(AWG)	Line Side : 12~1/0 / Load Side : 20~6
Rated voltage (Group C)(V)	600
Rated current (Group C)(A)	Line Side : 96 / Load Side : 55
Wire Ranget (Group D)(AWG)	Line Side : 12~1/0 / Load Side : 20~6
Rated voltage (Group D)(V)	600
Rated current (Group D)(A)	Line Side : 96 / Load Side : 55

Drawings

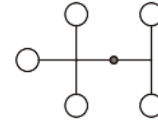
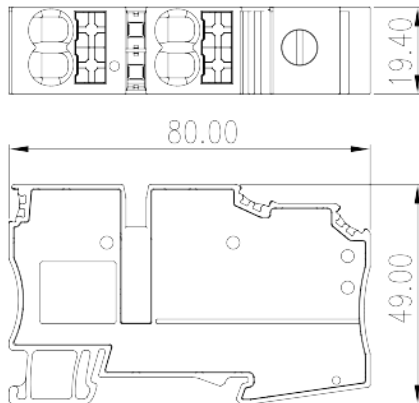

Approvals

